

# Aesculap® Single Use Surgical Instruments

Procedure Sets  
Instruments for Ward Use and Emergency Care



Aesculap Surgical Technologies

A new Standard in  
Surgical Instruments

**B | BRAUN**  
SHARING EXPERTISE

# Aesculap® SUSI®

Single Use Surgical Instruments



PACK PER CASE

## Pack per case – Procedure sets

„All inclusive“: – high quality single use instrumentation  
– all required consumables

At your finger tips! Ready for use when required:

- instantly available
- always complete
- always sterile (sterilised in acc. to validated sterilisation process)
- reliable
- procedure related cost transparency
- no additional service cost (e.g. repair cost, etc..)
- always up-to-date

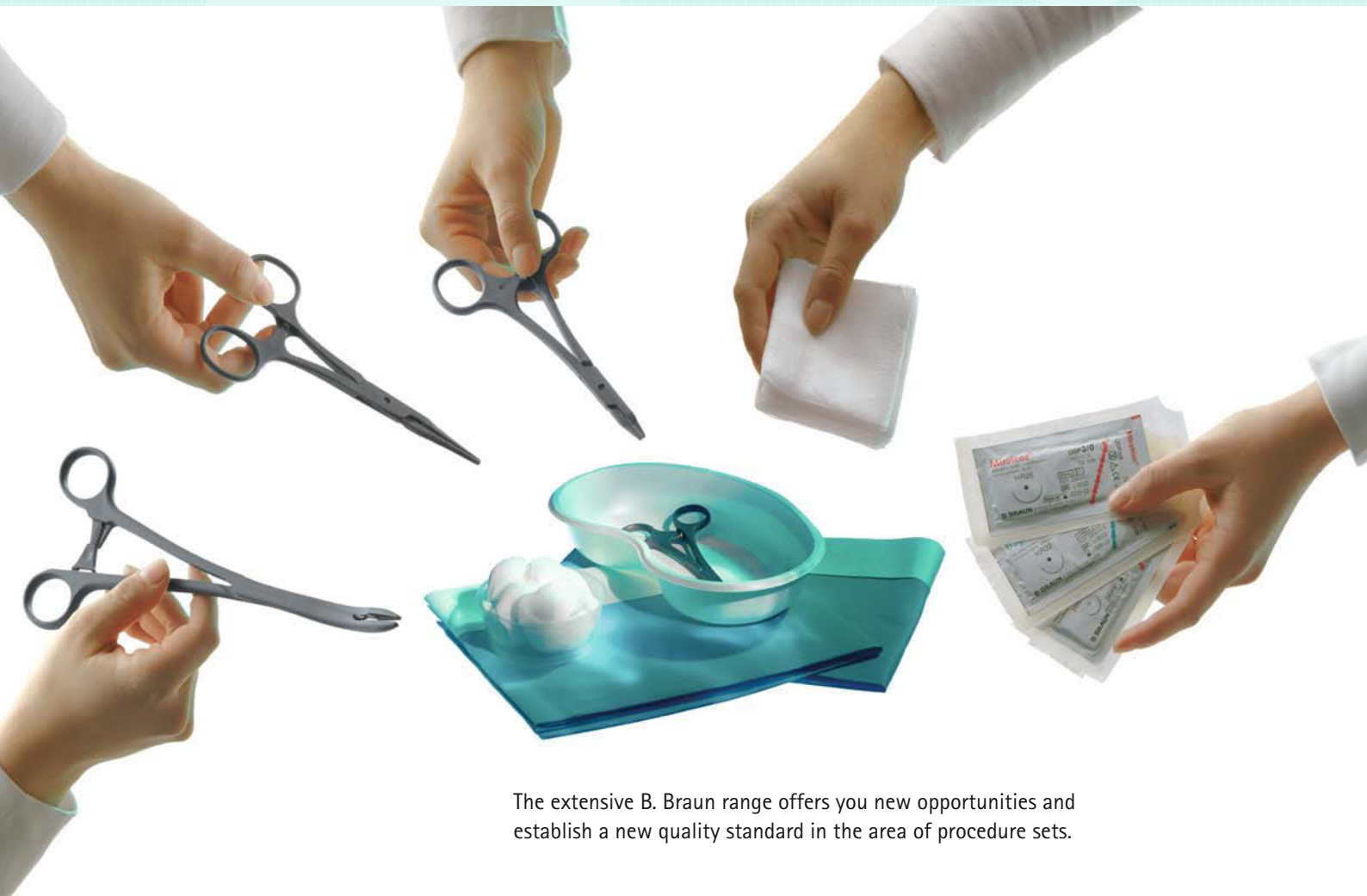

The extensive B. Braun range offers you new opportunities and establish a new quality standard in the area of procedure sets.



### Pack per case – The special set

B. Braun Aesculap procedure sets make a difference, independently if used for small procedures or for treatment of large wounds. Our "Pack per case" range of procedure sets include all the single use products which hospitals, clinics and practitioners rely upon every day. However the surgical instruments in the sets make the difference. They are high performance precision instruments, although designed for single use. No wonder, Aesculap instruments represent quality, economic efficiency and reliability since generations.

### SUSI® – The difference

SUSI® (Single Use Surgical Instruments) Instrumentation is a special range of single use surgical instruments. Utilising proven established design patterns and the use of light high performance polymers for the production provides you with high precision instruments with excellent mechanical properties. The material used allows simple and environmentally friendly incineration utilising existing disposal systems in hospitals.

SUSI® instruments are also available individually sterile packed in a dispenser box.

### The choice is yours – Establish a new standard

"Pack per case" procedure sets have proven their suitability on hospital wards, in intensive care units, A&E Departments, Outpatient Departments, Nursing homes, GP surgeries & practices and can also be used by ambulance services. For all these areas of application, SUSI® procedure sets not only offer medical advantages but also plenty of savings potential. Should you have specific needs and requirements (i.e custom made sets or economic analysis) please do not hesitate to contact us.

# Aesculap® SUSI®

Single Use Surgical Instruments

## 5061000 Suture Set 1



## 5061010 Surgical Dressing Set 1



### Contents

### Pieces

Defix kidney tray, white	1
Bowl, transparent, 120 ml	1
Gauze swabs, plumsized	5
SUSI® forceps Adson, sharp, 120 mm	1
SUSI® needle holder Mayo-Hegar, 150 mm	1
SUSI® scissors, sharp/blunt, 145 mm	1
SUSI® haemostatic forceps Pean, straight, 145 mm	1

Order unit: PAK = Pack of 20 sets

### Contents

### Pieces

Defix kidney tray, white	1
Bowl, transparent, 120 ml	1
Gauze compress, 7.5 x 7.5 cm, 8-fold (ply)	5
Gauze swabs, plumsized	5
SUSI® forceps Adson, sharp, 120 mm	1
SUSI® needle holder Mayo-Hegar, 150 mm	1
SUSI® scissors, sharp/blunt, 145 mm	1

Order unit: PAK = Pack of 20 sets

**5061020 Surgical Dressing Set 2**



**5061030 Surgical Dressing Set 3**



Contents	Pieces
Defix kidney tray, white	1
Bowl, transparent, 120 ml	1
Drape, 75 x 90 cm	1
Hole towel, 75 x 75 cm, adhesive area	1
Gauze compress, 7.5 x 7.5 cm, 12-fold (ply)	10
Gauze swabs, plumsize	5
SUSI® forceps Adson, sharp, 120 mm	1
SUSI® needle holder Mayo-Hegar, 150 mm	1
SUSI® scissors, sharp/blunt, 145 mm	1
SUSI® haemostatic forceps Pean, straight, 145 mm	1
Order unit: PAK = Pack of 20 sets	

Contents	Pieces
Defix kidney tray, white	1
Bowl, transparent, 120 ml	1
Gauze compress, 7.5 x 7.5 cm, 8-fold (ply)	5
Gauze swabs, plumsize	5
SUSI® tissue forceps, sharp, 145 mm	1
SUSI® scissors, sharp/blunt, 145 mm	1
Order unit: PAK = Pack of 20 sets	

# Aesculap® SUSI®

Single Use Surgical Instruments

## 5061040 Suture Removal Set 1



## 5061050 Suture Removal Set



Contents	Pieces
Defix kidney tray, white	1
Mini compress, 25 x 25 mm	17
SUSI® forceps, sharp, ADSON, 120 mm	1
SUSI® scissors, sharp/sharp, 110 mm	1
Order unit: PAK = Pack of 20 sets	

Contents	Pieces
Defix kidney tray, white	1
Cutfix Stitch Cutter	1
Gauze compress, 5 x 5 cm, 8-fold (ply)	2
SUSI® dissecting forceps Adson, fine, 120 mm	1
Order unit: PAK = Pack of 20 sets	

## 5062000 Thorax Drainage Set, small



Contents	Pieces
Plastic tray, blue	1
Vasco surgical gloves, size 7.5	1
Drape, 45 x 75 cm	1
Hole towel, 75 x 110 cm, blue	1
Gauze compress with slit, 10 x 10 cm, 12-fold (ply)	2
Gauze compress, 10 x 10 cm, 12-fold (ply)	5
Cutfix disposable scalpel size 11	1
SUSI® Metzenbaum dissecting scissors, curved, 180 mm	1
SUSI® needle holder Mayo-Hegar, 150 mm	1
SUSI® tubing clamp, 135 mm	1
Suture Premilene® 2/0, 75 cm, DS39 (M)	2
Order unit: PAK = Pack of 5 sets	

# Aesculap® SUSI®

## Single Use Surgical Instruments

### 5062010 Thorax Drainage Set, large



Contents	Pieces
Plastic tray, 31 x 28.5 x 5 cm	1
Drape, 75 x 90 cm	1
Surgical gloves, size 7.5, powder free	1
Gauze compress, 10 x 10 cm, 12-fold (ply)	8
Slit compress, 10 x 10 cm, 12-fold (ply)	2
Bowl, round, 250 ml	1
SUSI® dressing forceps, curved, 265 mm	1
Drape, 75 x 100 cm, self adhesive	2
Injection syringe, Luer, 10 ml	1
Sterican® cannula size 1, G 20 x 1 1/2, Ø 0.90 mm, 40 mm, yellow	1
Sterican® cannula, LL, G 18 x 1 1/2, Ø 1.20 mm, 40 mm, pink	1
Sterican® cannula, LL, G 20 x 2 3/4, Ø 0.90 mm, 70 mm, yellow	1

Contents	Pieces
Sterican® cannula size 12, G 22 x 1 1/4, Ø 0.70 mm, 30 mm, black	1
Cutfix disposable scalpel size 11	1
SUSI® tissue forceps, sharp, 145 mm	1
SUSI® Metzenbaum dissecting scissors, 180 mm	1
SUSI® needle holder Mayo-Hegar, 150 mm	1
SUSI® tubing clamp, 135 mm	1
Suture Premicron green 0 (3.5), 75 cm, DS 30 (M)	1
Suture Dafilon blue 3/0 (2), 75 cm, 1 x DS 19	1
Askina® fix fixation plaster, 15 x 20 cm	2
<b>Order unit: PAK = Pack of 5 sets</b>	
Developed in cooperation with: Dr. med. Thomas Kiefer, Klinikum Offenburg, Ebertplatz 12, 77654 Offenburg, Germany	



## 5062020 Thorax Drainage Set



Contents	Pieces
Plastic Tray, light blue, 250 x 137 x 57 mm	1
Hole towel, 75 x 110 cm, blue	1
Askina® fix fixation plaster, 15 x 20 cm	1
Slit compress, 10 x 10 cm, 12-fold (ply)	2
Askina® gauze compress, 12-fold (ply), 10 x 10 cm	5
SUSI® sponge forceps, curved, 200 mm	1
SUSI® tissue forceps, 1 x 2 teeth, 145 mm	1
SUSI® dissecting scissors Metzenbaum, curved, 180 mm	1
SUSI® needleholder Mayo-Hegar, straight, 150 mm	1
SUSI® tubing clamp, 135 mm	1
Disposable scalpel size 11	1
Single use razor	2
Injection syringe, Luer, 10 ml	1

Contents	Pieces
Sterican® cannula size 1, G 20 x 1 1/2, Ø 0.90 mm, 40 mm yellow	1
Sterican® cannula size 12, G 22 x 1 1/4, Ø 0.70 mm, 30 mm black	1
Sterican® cannula, deep intra-muscular, LL G 20 x 2 3/4, Ø 0.90 mm, 70 mm, yellow	1
Drape 78 x 90 cm	1
Suture Premilene® 2/0 (3) 75 cm, DS39 (M)	2
Suture Dagrofil® green 0 (3.5) 75 cm, 1 x DS30	1
Order unit: PAK = Pack of 5 sets	

# Aesculap® SUSI®

Single Use Surgical Instruments

## 5063000 SUSI® Port Set



Contents	Pieces
Struma-Drape, T-Form, 198/259 x 30 cm	1
Tray 28 x 38 x 3 cm	1
Sterican® cannula size 2, G 21 x 1 1/2, Ø 0.80 mm, 40 mm, green	1
Sterican® cannula size 12, G 22 x 1 1/4, Ø 0.70 mm, 30 mm, black	1
Cutfix disposable scalpel size 10	1
Disposable electrode handle	1
Suture Safil® violet 3/0 (2) 70 cm, HR26	2
Suture Monosyn® undyed 4/0 (1.5) 45 cm, 1 x DSM19	1
Injection syringe, Luer, 10 ml	2
Askina® Soft steril, 9 x 10 cm	1
SUSI® dissecting forceps Adson, fine, 120 mm	1
SUSI® tissue forceps, 1 x 2 teeth, 145 mm	2
SUSI® dissecting scissors Metzenbaum, curved, 180 mm	1

Contents	Pieces
SUSI® needleholder, Mayor-Hegar, 150 mm	1
SUSI® self-retaining retractor Weitlaner, 3 x 4 teeth, 130 mm	1
SUSI® retractor Roux, 170 mm	1
Gauze compress, 16-fold (ply), 10 x 10 cm, X-ray marker	20
Operation gown, Size L	3
Tablebag, 75 x 141 cm	1
Cover drape, 152 x 193 cm	1
Order unit: PAK = Pack of 5 sets	

## 5063010 SUSI® Cardiac Pacemaker Set



Contents	Pieces
Cover drape 236 x 300 cm, with slit 9 x 108 cm	1
Anesthesia drape 152 x 250 cm	1
Cover drape, self-adhesive, 75 x 90 cm	2
C-Bend cover 70 + 43 x 200 cm	1
Tray, 33 x 30 x 6 cm, white	1
Bowl round, 250 ml, light blue	1
Gauze swabs, round, 40 x 40 cm, X-ray marker	5
Gauze compress, 12-fold (ply), 10 x 10 cm, X-ray marker	20
Cutfix disposable scalpel size 22	1
Omnifix injection syringe, Luer, Lock, 20 ml	1
Sterican® cannula size 1, G 20 x 1 1/2, Ø 0.90 mm, 40 mm, yellow	1
Sucker bag 33 x 41 cm, 2 chambers, self-adhesive	1
Disposable electrode handle	1
SUSI® Mosquito forceps, curved, 125 mm	2
SUSI® dissecting scissors Metzenbaum, curved, 180 mm	1

Contents	Pieces
SUSI® haemostatic forceps Birkett, curved, 185 mm	2
SUSI® needleholder Crile Wood, straight, 200 mm	1
SUSI® tissue forceps Waughs, 200 mm	1
SUSI® sponge forceps, curved, 265 mm	1
SUSI® dissecting forceps Cushing, 200 mm	1
SUSI® self-retaining retractor Weitlaner, 3 x 4 teeth, 130 mm	1
SUSI® retractor Roux, 170 mm	1
Bowl, round, 120 ml, transparent	2
Askina® Soft 9 x 10 cm	1
Suture Monosyn® violet 3/0 (2), 70 cm, HR26	1
Suture Monosyn® undyed 4/0 (1.5), 70 cm, DSMP24	1
Suture Silkam® black 0 (3.5), 75 cm, 1 x HR26	1
Operation gown, Size L	2
Table bag, 75 x 141 cm	1
Table cover, 152 x 193 cm	1
Order unit: PAK = Pack of 4 sets	

# Aesculap® SUSI®

Single Use Surgical Instruments

## 5063020 SUSI® Varicose Veins Set



Contents	Pieces
Anesthesia drape, 183 x 300 cm	1
U-Drape, 193 x 304 cm	1
Cover drape, 102 x 150 cm	1
3-Pocket tray, 24 x 25 x 5 cm	1
Suture collector, 4 pockets	1
Preparation swab ball, middle, size 2, X-ray marker	5
Gauze swabs, plumsize, round, 20 x 20 cm, X-ray marker	10
Gauze compress, 16-fold (ply), 10 x 10 cm, X-ray marker	20
Disposable scalpel size 11	1
Askina® Elast fixation bandage, 4 m x 12 cm	1
Askina® Soft sterile, 7,5 x 5 cm	8
Askina® Soft sterile, 9 x 10 cm	1
Askina® universal bandage 5 m x 8 cm	1

Contents	Pieces
Askina® universal bandage 5 m x 10 cm	2
Suture Safil® violet 3/0 (2) 6 x 45 cm	1
Suture Safil® violet 0 (3.5) 70 cm, HR30	1
Suture Monosyn® undyed 4/0 (1.5) 45 cm, DS19	1
Suture Monosyn® undyed 4/0 (1.5) 70 cm, DS19	1
SUSI® needleholder Crile Wood, straight, 200 mm	1
SUSI® tissue forceps Adson, fine, 120 mm	1
SUSI® dissecting forceps Adson, fine, 120 mm	1
SUSI® Mosquito forceps, straight, 125 mm	3
SUSI® Mosquito forceps, curved, 125 mm	1
SUSI® dissecting scissors Metzenbaum, curved, 180 mm	1
SUSI® self-retaining retractor Weitlaner, 3 x 4 teeth, 130 mm	1
SUSI® retractor Roux, 170 mm	1

Contents	Pieces
Abdominal drape, 6 ply, white, 45 x 45 cm, X-ray marker	5
Venostrip Vein exstirpations-set	1
Operation gown, Size L	3
Tablebag, 75 x 141 cm	1
Surgical gloves, size 8, powder free	1
Cover drape, 152 x 193 cm	1
Order unit: PAK = Pack of 4 sets	

# Aesculap® SUSI®

Single Use Surgical Instruments



CLINIC LINE

## A new standard for surgical instruments

SUSI® (Single Use Surgical Instruments) is a unique range of surgical instruments. With SUSI® you get high level innovation and performance in a new but at the same time familiar and proven design. SUSI® instruments are manufactured from a light, high performance polymer. The special composition of this polymer ensures outstanding accuracy and offers excellent mechanical characteristics.

In developing SUSI® ClinicLine, we have focussed in particular on the requirements on the ward and in outpatient departments. In these areas it is essential to have sterile, functional and safe surgical instruments available quickly and at low process costs. With SUSI® ClinicLine we can offer you the right solution.





## SUSI® helps you in your daily work with many positive features and advantages

### Safety

SUSI® reduces the risk of cross-contamination through surgical instruments.

### Quality assurance

- With SUSI® you always have a new instrument which ensures 100% functionality for the intended use
- SUSI® will be supplied sterile packed and are sterilised in a validated process

### Economical Aspects

- SUSI® provides a clear cost allocation according to DRGs
- SUSI® leads to a reduction of processing costs in the hospital

### Material

SUSI® are made from a high performance polymer. The special composition of this high-grade polymer ensures an outstanding quality and provides optimal mechanical properties for the intended function of each instrument. This material ensures a safe, easy and environmentally friendly removal through incineration in the regular hospital waste removal system.

### Packaging

SUSI® are sterile packed in single peel packs. The single peel packs are presented in dispenser boxes containing an indicated quantity of units as described in this leaflet.





# Aesculap® SUSI®

Single Use Surgical Instruments



AN915SU	SUSI® Tubing Clamp
Dimension	135 mm, 5 5/16"
Sales Unit	20 pieces, sterile, single packed in dispenser box

BF046SU	SUSI® Sponge Forceps
Name	GROSS
Description	straight, with universal ratchet
Dimension	200 mm, 8"
Sales Unit	20 pieces, sterile, single packed in dispenser box





3/4



3/4

BF059SU	SUSI® Sponge Forceps
Description	curved, with universal ratchet
Dimension	265 mm, 10 1/2"
Sales Unit	20 pieces, sterile, single packed in dispenser box

BF047SU	SUSI® Sponge Forceps
Name	GROSS
Description	curved, with universal ratchet
Dimension	200 mm, 8"
Sales Unit	20 pieces, sterile, single packed in dispenser box

# Aesculap® SUSI®

Single Use Surgical Instruments



BC110SU	SUSI® Fine Scissors
Description	sh/sh, straight
Dimension	110 mm, 4 3/8"
Sales Unit	20 pieces, sterile, single packed in dispenser box

BC324SU	SUSI® Surgical Scissors
Description	sh/bl, straight
Dimension	145 mm, 5 3/4"
Sales Unit	20 pieces, sterile, single packed in dispenser box



1/1



1/1

<b>BC606SU</b>	<b>SUSI® Dissecting Scissors</b>
Name	METZENBAUM
Description	curved
Dimension	180 mm, 7"
Sales Unit	20 pieces, sterile, single packed in dispenser box

<b>BC790SU</b>	<b>SUSI Umbilical Cord Scissors Blue</b>
<b>BC791SU</b>	<b>SUSI Umbilical Cord Scissors Rose</b>
Description	curved
Dimension	160 mm, 6 ¼ "
Sales Unit	20 pieces, sterile, single packed in dispenser box

# Aesculap® SUSI®

Single Use Surgical Instruments



BD222SU	SUSI® Dissecting Forceps
Name	ADSON
Description	w/o teeth, fine
Dimension	120 mm, 4 3/4"
Sales Unit	20 pieces, sterile, single packed in dispenser box

BD512SU	SUSI® Tissue Forceps
Name	ADSON
Description	1 x 2 teeth, fine
Dimension	120 mm, 4 3/4"
Sales Unit	20 pieces, sterile, single packed in dispenser box



1/1



1/1

BD047SU	SUSI® Dissecting Forceps
Description	w/o teeth
Dimension	145 mm, 5 3/4"
Sales Unit	20 pieces, sterile, single packed in dispenser box

BD557SU	SUSI® Tissue Forceps
Description	1 x 2 teeth
Dimension	145 mm, 5 3/4"
Sales Unit	20 pieces, sterile, single packed in dispenser box

# Aesculap® SUSI®

Single Use Surgical Instruments



3/4



3/4

BD239SU	SUSI® Dissecting Forceps
Name	CUSHING
Description	serrated
Dimension	200 mm, 8"
Sales Unit	20 pieces, sterile, single packed in dispenser box

BD671SU	SUSI® Tissue Forceps
Name	WAUGHS
Description	1 x 2 teeth
Dimension	200 mm, 8"
Sales Unit	20 pieces, sterile, single packed in dispenser box



22 mm



28,6 mm



38 mm

GK609SU	SUSI® Bipolar Coagulation Forceps
Description	straight, w/o cable
Dimension	200 mm, 8" tip width 1.5 mm
Sales Unit	20 pieces, sterile, single packed in dispenser box

GK290SU - GK292SU	SUSI® Bipolar Cable
Dimension	3.7 m
Pin Distance	22 mm 28.6 mm 38 mm
Sales Unit	10 pieces, sterile, single packed in dispenser box

# Aesculap® SUSI®

Single Use Surgical Instruments



BH110SU	SUSI® Mosquito Forceps
Name	HALSTED
Description	straight
Dimension	125 mm, 4 7/8"
Sales Unit	20 pieces, sterile, single packed in dispenser box

BH111SU	SUSI® Mosquito Forceps
Name	HALSTED
Description	curved
Dimension	125 mm, 4 7/8"
Sales Unit	20 pieces, sterile, single packed in dispenser box





BH196SU	SUSI® Haemostatic Forceps
Name	BIRKETT
Description	straight
Dimension	185 mm, 7 1/4"
Sales Unit	20 pieces, sterile, single packed in dispenser box

BH197SU	SUSI® Haemostatic Forceps
Name	BIRKETT
Description	curved
Dimension	185 mm, 7 1/4"
Sales Unit	20 pieces, sterile, single packed in dispenser box

# Aesculap® SUSI®

Single Use Surgical Instruments



BH424SU	SUSI® Haemostatic Forceps
Name	PEAN
Description	straight
Dimension	145 mm, 5 3/4"
Sales Unit	20 pieces, sterile, single packed in dispenser box



BM235SU	SUSI® Needle Holder
Name	MAYO-HEGAR
Dimension	150 mm, 6"
Sales Unit	20 pieces, sterile, single packed in dispenser box

BM226SU	SUSI® Needle Holder
Name	CRILE WOOD
Dimension	200 mm, 8"
Sales Unit	20 pieces, sterile, single packed in dispenser box

# Aesculap® SUSI®

Single Use Surgical Instruments



3/4



3/4

BV067SU	SUSI® Self-Retaining Retractor
Name	WEITLANER
Description	semi-sharp, 3 x 4 teeth
Dimension	130 mm, 5 1/8"
Sales Unit	20 pieces, sterile, single packed in dispenser box

BT028SU	SUSI® Retractor
Name	ROUX
Description	blade sizes 36 x 20 mm & 20 x 15 mm
Dimension	170 mm, 6 3/4"
Sales Unit	20 pieces, sterile, single packed in dispenser box



3/4



1/2

FK850SU	SUSI® Curette
Description	sharp, round workpiece 7 mm oval workpiece 9 x 6 mm
Dimension	215 mm, 8 1/2"
Sales Unit	20 pieces, sterile, single packed in dispenser box

OM760SU	SUSI® Tonsil Snare
Name	EVES
Description	with 2 wire loops
Dimension	285 mm, 11"
Sales Unit	10 pieces, sterile, single packed in dispenser box

# Aesculap® SUSI®

Single Use Surgical Instruments

 PACK PER CASE

Product Code	Description	Page
5061000	Suture Set 1	4
5061010	Surgical Dressing Set 1	4
5061020	Surgical Dressing Set 2	5
5061030	Surgical Dressing Set 3	5
5061040	Suture Removal 1	6
5061050	Suture Removal	6
5062000	Thorax Drainage Set, small	7
5062010	Thorax Drainage Set, large	8
5062020	Thorax Drainage Set	9
5063000	SUSI® Port Set	10
5063010	SUSI® Cardiac Pacemaker Set	11
5063020	SUSI® Varicose Vein Set	12
AN915SU	SUSI® Tubing Clamp	16
BC110SU	SUSI® Fine Scissors	18
BC324SU	SUSI® Surgical Scissors	18
BC606SU	SUSI® Dissecting Scissors	19
BD047SU	SUSI® Dissecting Forceps	21
BD222SU	SUSI® Dissecting Forceps	20
BD239SU	SUSI® Dissecting Forceps	22

 CLINIC LINE



Product Code	Description	Page
BD512SU	SUSI® Tissue Forceps	20
BD557SU	SUSI® Tissue Forceps	21
BD671SU	SUSI® Tissue Forceps	22
BF046SU	SUSI® Sponge Forceps	16
BF047SU	SUSI® Sponge Forceps	17
BF059SU	SUSI® Sponge Forceps	17
BH110SU	SUSI® Mosquito Forceps	24
BH111SU	SUSI® Mosquito Forceps	24
BH196SU	SUSI® Haemostatic Forceps	25
BH197SU	SUSI® Haemostatic Forceps	25
BH424SU	SUSI® Haemostatic Forceps	26
BM226SU	SUSI® Needle Holder	27
BM235SU	SUSI® Needle Holder	27
BT028SU	SUSI® Retractor	28
BV067SU	SUSI® Self-Retaining Retractor	28
FK850SU	SUSI® Curette	29
GK290SU GK291SU GK292SU	SUSI® Bipolar Cable	23
GK609SU	SUSI® Bipolar Coagulation Forceps	23
OM760SU	SUSI® Tonsil Snare	29



