

evercare[®] Adhesive split sheet 150x183 cm split 7x70 cm

REF: 1308

evercare[®] Adhesive split sheet, sterile provides a versatile easy-to-use draping solutions for wide range of procedures in orthopaedics, ear/nose/throat, thoracic and general surgery.

Key Features

- ▶ Easy-to-use draping
- ▶ Available in a wide range of sizes and designs
- ▶ Complies to EN 13795-1 High performance critical product area requirements

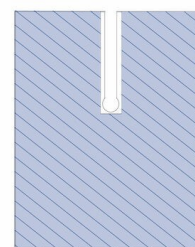

150 x 183 cm
U = 7 x 70 cm

REF	DESCRIPTION	SIZE	Pack Count dispenser/carton
1308	Adhesive split sheet, sterile, Blue	150 x 183 cm, split 7 x 70 cm	9 / 36

Sales Unit: Transport Carton

Regulations

The product complies with legal requirements for medical devices. EO sterilized according to valid version of ISO 11135 standard.

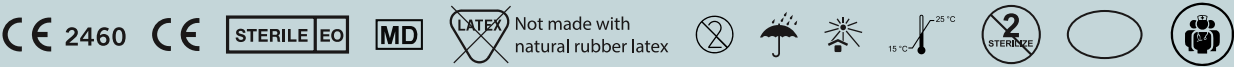

REACH regulation:	The products covered by this data sheet do not contain substances classified as carcinogenic, mutagenic or toxic for reproduction (CMR), including any of the Substances of Very High Concern (SVHC) as listed in the latest available version of the Candidate List published by European Chemicals Agency (ECHA).
Biological evaluation:	EN ISO 10993-01 EN ISO 10993-5 EN ISO 10993-7 EN ISO 10993-10
Compliance with legal requirements:	Medical Device Regulation (EU) 2017/745, MDR class Is
Compliance with product standards:	EN13795-1
Quality standards:	EN ISO 13485
Label information and packaging compliance:	EN ISO 15223-1, EN ISO 20417, EN ISO 11607-1

Material

Product Part	Raw Material & Characteristics
Laminate	PP nonwoven, blue / PE-film, blue / PP nonwoven, white

Warnings & Recommendations

Warnings	The product is single use. If reused, the performance of product may deteriorate and cross contamination may occur. Do not use if package is damaged.
Storage Recommendation	Recommended storage in clean, dry space in ambient temperature. Products should be protected from direct sunlight, other intensive light sources and ozone.
Disposal Recommendation	Dispose in accordance with local regulations.
Shelf Life	5 years

Packing Information

Package	Material	Size (L x W x H) mm
Single Pack	Medical grade paper, PE/PET film	250 x 390
Dispenser Pack	TCF or ECF quality	285 x 242 x 287
Transport Carton	TCF or ECF quality	500 x 310 x 590
Packing Tape	Transparent	N/A

Barcodes / UDI-DI

REF	Single Pack	Dispenser	Transport Carton
1308	06438129118575	06438129318579	06438129518573

Evercare Medical AB is a partner that enables better lives for patients, facilitates everyday life for healthcare employees and contributes to lower care costs. We strive to reduce the environmental impact and, together with our suppliers, to improve working conditions throughout the value chain.